

Limitedbrands

LIMITED STORE PLANNING, INC.  
d/b/a STORE DESIGN & CONSTRUCTION  
Three Limited Parkway • Columbus, Ohio 43230  
Telephone: 614.415.7000 • Fax: 614.415.7349

THESE DRAWINGS AND SPECIFICATIONS HAVE BEEN PREPARED FOR USE ON A SPECIFIC TYPE OF CONSTRUCTION. THE CONTRACTOR SHALL BE RESPONSIBLE FOR OBTAINING ALL NECESSARY PERMITS AND FOR THE PROTECTION OF THE EXISTING UTILITIES. THE CONTRACTOR SHALL BE RESPONSIBLE FOR THE PROTECTION OF THE EXISTING UTILITIES. THE CONTRACTOR SHALL BE RESPONSIBLE FOR THE PROTECTION OF THE EXISTING UTILITIES.

161
KG 1+
141Sa
30840

PROJECT INFORMATION:

**24**

**BATH & BODY WORKS**

**THE GALLERIA II**

SPACE NO. B3580

5065 WESTHEIMER RD.

HOUSTON, TX 77056

DESIGN TYPE: FULL REMODEL

DESIGN PERIOD: 4/00

PERMIT NO. 00061216

4/00

REVISIONS:		
	REQUIRED BY:	DATE
1	BUILDING DEPARTMENT COMMENTS	04/11/11
2	BUILDING DEPARTMENT COMMENTS	05/8/11
3	DESIGN CHANGES/ LANDLORD COMMENTS/ MASTERS UPDATES	05/28/11
4	DESIGN CHANGES	06/27/11
5	DESIGN CHANGES	07/24/11

DATE ISSUED: 3/7/14  
DESIGNED BY: S  
DRAWN BY: JLB  
CHECKED BY: RHW

NON-SALES  
PLANS  
CONTINUED

DRAWING NUMBER:

A02.2a

REFLECTED CEILING PLAN

- IF NOT ALREADY EXISTING, TENANT MUST PROVIDE A SEALED PARTITION ABOVE THE STOREFRONT TO SEPARATE THE COMMON AREA CEILING FROM THE TENANT'S SPACE. (SHALL BE RATED IF REQUIRED BY CODE AND ALL PENETRATION SHALL COMPLY AND BE LABELED WITH THE REQUIRED NFPA RATING.)
- IF PENETRATION TO BE EXISTING, SUSPENDED FROM, OR PENETRATE LANDLORD'S STRUCTURE, FLOOR, DECK, OR ROOF DECK, TENANTS MAY ATTACH NONDESTRUCTIVELY, TO OR SUSPEND FROM THE TOP CHORD OF THE JOIST OR THE STRUCTURAL STEEL WHICH EXISTS ABOVE THE TENANT SPACE. WHEN ATTACHING TO LANDLORD'S STRUCTURE, DO NOT DRILL, WELD, SCREEN, OR SHOOT INTO STRUCTURE. ALTERNATIVE METHODS OF ATTACHMENT ONLY: NOTHING TO DAMAGE LANDLORD'S BASE OR STRUCTURE. STRUCTURE SHALL BE IDENTIFIED BY REFERENCE TO THE STRUCTURAL DRAWINGS, BY A STRUCTURAL ENGINEER WITH LEGALLY ACTIVE REGISTRATION AS INDICATED BY ALL JURISDICTIONAL REQUIREMENTS, FOR ALL STRUCTURAL MODIFICATIONS FOR LANDLORD RECORDS.
- LANDLORD EQUIPMENT, COMPONENTS, AND / OR SERVICE FEEDING OTHER TENANTS, THAT IS EXISTING IN SPACE MUST REMAIN VISIBLE AND ACCESSIBLE TO THE LANDLORD. TENANT SHALL INSTALL ACCESS PANELS AS REQUIRED TO MAINTAIN ACCESS. ACCESS PANELS SHALL BE LABELED TO PROPERLY IDENTIFY SYSTEM, COORDINATE WITH PANEL OPERATIONS
- SINCE PROPERTY GROUPS REQUIRE ALL TENANTS TO USE LANDLORD'S REQUIRED CONTRACTOR FOR ALL SPRINKLER WORK, REFER TO SPRINKLER COMMENTS FOR FURTHER REQUIREMENTS

SPRINKLER COMMENTS

- \* ALL SPRINKLER WORK (SHOP DRAWINGS) TO BE APPROVED BY LANDLORD'S INSURER
- \* SUBMIT PLANS TO: GLOBAL RISK CONSULTANTS - SEE BELOW
- \* SPRINKLER SYSTEM MUST BE FULLY CHARGED AND OPERATIONAL WHENEVER CONTRACTOR IS NOT ON SITE
- \* SIMON PROPERTY GROUP REQUIRES ALL TENANTS TO USE SIMPLEX GRINNELL FOR ALL SPRINKLER WORK
- \* AT TIME OF BIDDING, TENANT OR T.G.C. SHOULD CONTACT SIMPLEX GRINNELL'S NATIONAL ACCOUNTS REPRESENTATIVE TO OBTAIN DIRECTION FOR PRICING AND SCHEDULING.
- \* 800-299-4377 / OPTION #4
- \* TENANT OR T.G.C. IS REQUIRED TO CONTRACT WITH AND PAY FOR ALL TENANT SPRINKLER WORK DIRECTLY WITH SIMPLEX GRINNELL.
- \* SIMON PROPERTY GROUP REQUIRES ALL TENANTS TO USE LANDLORD'S PRE-QUALIFIED SPRINKLER CONTRACTORS FOR TENANT'S SPRINKLER WORK. TENANT HAS NO COMPETITIVE BID. ONLY THOSE QUALIFIED CONTRACTORS PRE-QUALIFIED BY LANDLORD (CONTACT THAT MAIL MANAGER OR OPERATIONS DIRECTOR FOR A LIST PRE-QUALIFIED SPRINKLER CONTRACTORS).

FOR CONTINUATION OF PLAN,  
SEE A05.1 & A06.1

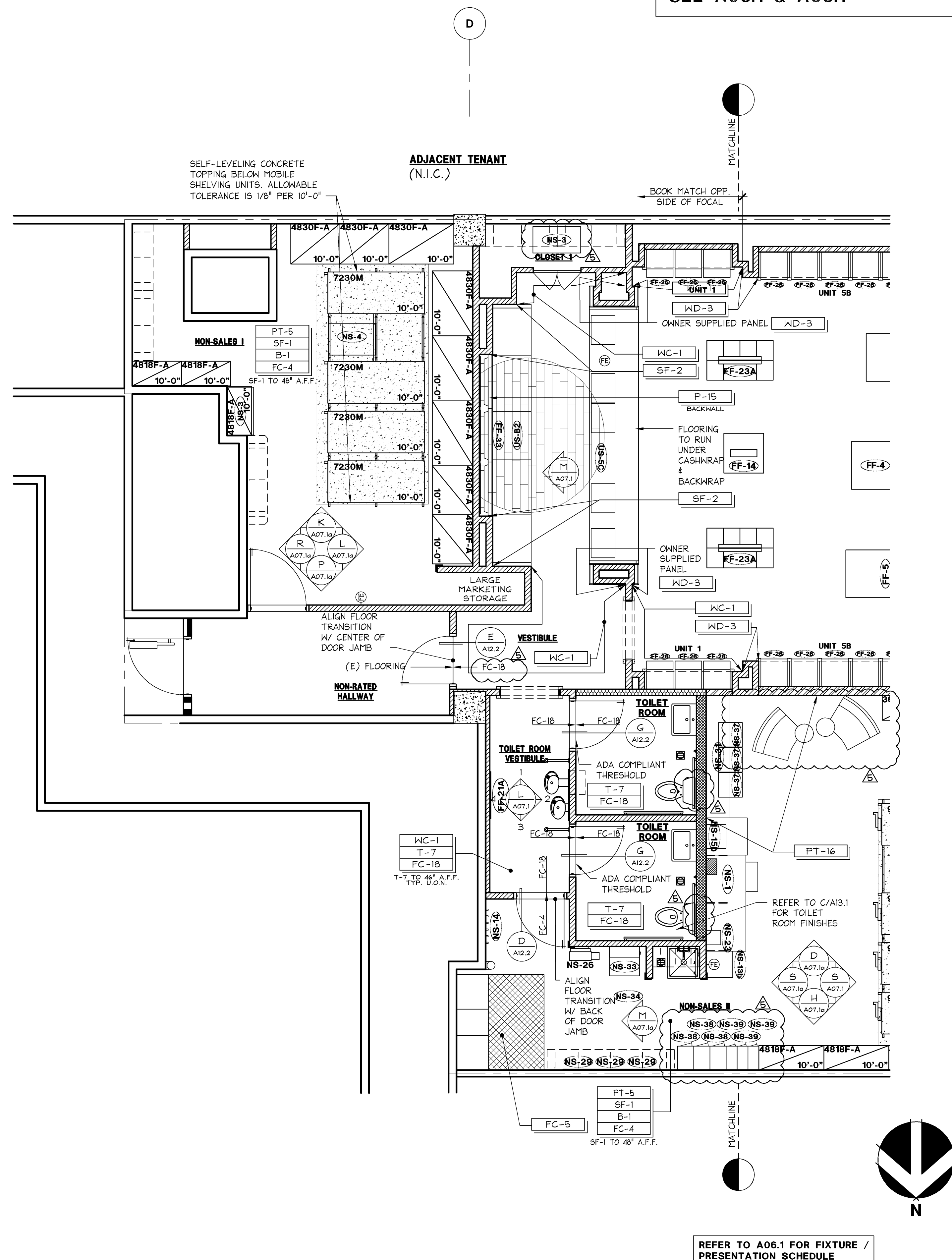

REFER TO A06.1 FOR FIXTURE /  
PRESENTATION SCHEDULE

## NON-SALES FINISH & PRESENTATION PLAN

<b>1/4" = 1'-0"</b>	<b>J</b> 10.14.13
<b>42P-A021-A00-PLAN</b>	

### NON-SALES REFLECTED CEILING PLAN

FOR CONTINUATION OF PLAN,  
SEE A04.1

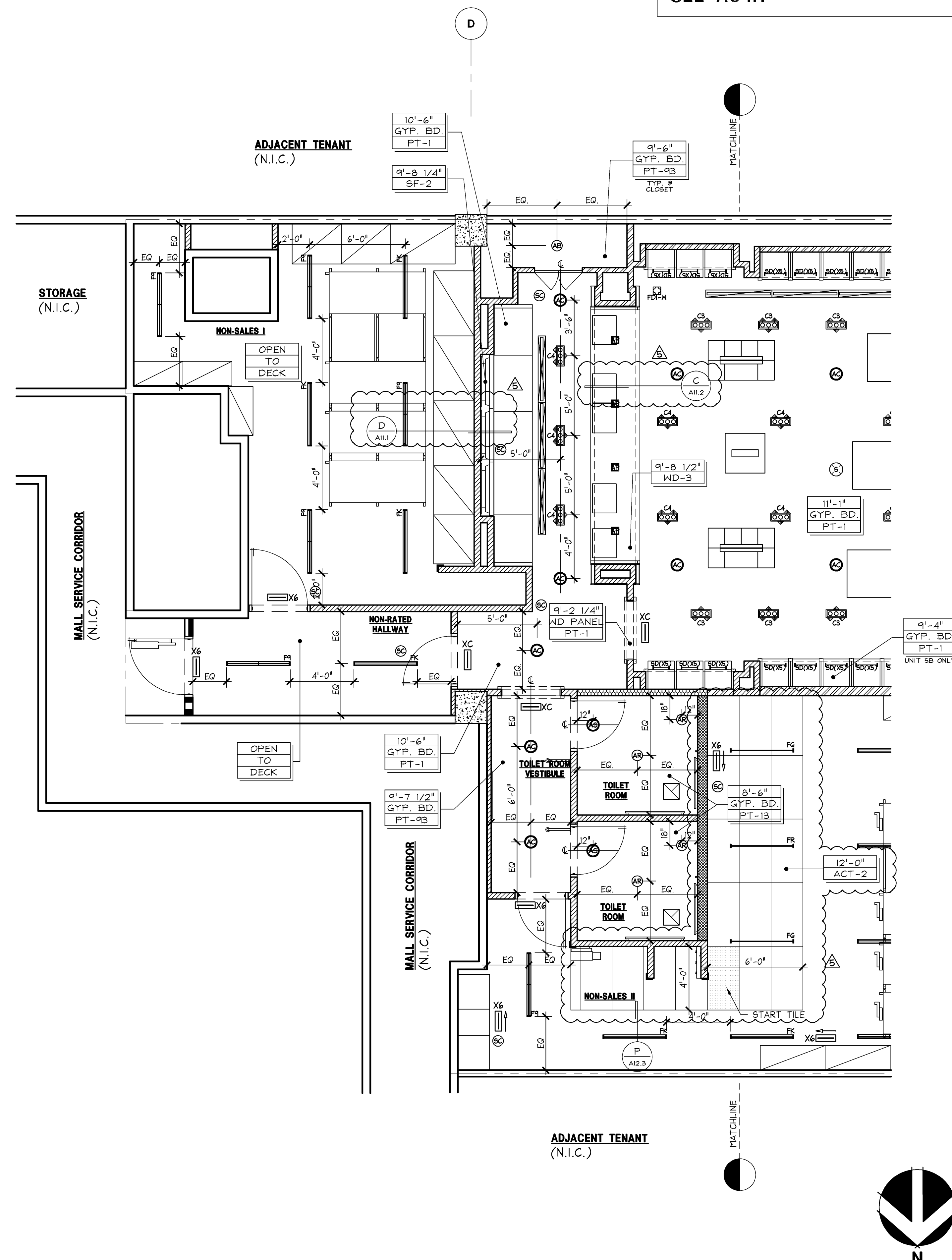

**ADJACENT TENANT**  
(N.I.C.)

<b>1/4" = 1'-0"</b>	<b>A</b>
<b>42P-A021-A00-PLAN</b>	

### NON-SALES REFLECTED CEILING PLAN